



Service Information

Frontloader Washing machine

AWO/D 5526

8592 968 15000

Last Modification: 02/01/09

Spare Part List	2
Exploded View	4
Technical Data	6
Wiring Diagram	8
Circuit Diagram	10
Program Chart	12
Testprogram	21
Error Codes	22

This document is only intended for qualified technicians who are aware of the respective safety regulations.
Subject to modifications

Spare Part List

Pos No	12NC	Description
001 0	4812 440 11538	Cabinet
011 0	4812 462 48421	Adjust. foot
021 0	4812 440 11564	Front 50 l
024 0	4812 440 11544	Panel rear
024 1	4812 441 38021	Holder hose outlet
025 0	4812 440 11472	Support control board
030 0	4812 440 11473	Table top UBS possible
040 0	4812 417 18787	Hinge
050 0	4812 440 10779	Plinth GW
061 0	4812 466 89017	Counter weight upper, Eureka 50-54l
061 1	4812 466 89018	Counter weight front, bottom, Eureka 50l
061 2	4812 310 39249	Mounting kit Counter weight
081 0	4812 466 48088	Shock absorber 1400
084 0	4812 466 58001	Silent bloc
086 0	4812 401 18894	Fastener shock absorber
086 2	4812 401 18412	Stopper
110 0	4812 498 18361	Handle door
130 0	4812 417 28047	Plate Door lock
130 1	4812 417 28108	Plate Doorlock Lower
131 0	4812 417 28046	Lock Door
131 1	4812 417 28045	Pin Door Lock
131 2	4812 492 58022	Spring Door Lock
135 1	4812 498 18262	Knob Door safety GW
135 2	4812 492 58023	Spring Door Safety
135 3	4812 290 68153	Holder adjust. Door Safety
140 0	4812 450 59812	Door glass DELTA EUREKA
143 0	4812 440 11141	Glassdoor frame
144 0	4812 440 11139	Frame door glas
144 3	4812 502 18669	Screw 4.0x12
191 0	4812 460 68633	Door bellow Eureka 473
191 1	4812 492 18028	Strap Eureka
191 2	4819 530 58059	Ring
200 0	4812 418 18727	Wash unit Eureka/1200/50L-weld
223 0	4812 418 48978	Drum lifter plastic 50L
271 0	4812 358 18214	Belt POLY-V-1238/J4
272 0	4812 528 58044	Pulley Eureka/MR+HR
272 3	4812 502 18817	Screw pulley M8x23 Eureka
301 0	4801 111 00295	Control panel + handle drawer
331 0	4812 414 58306	Knob timer EBL WP25
331 3	4812 414 58307	Spring Knob timer
332 0	4812 513 18174	Push button 7 opt
333 0	4812 513 18172	Push button start-reset
400 0	4812 361 58509	Motor MCA52/64-148WHE18
400 1	4812 502 18816	Screw P8x50
409 0	4812 362 48004	Brush,carbon motor CESET
421 0	4812 121 18285	Interf.filter 1,00 μ F
430 0	4812 360 18559	Pump
451 0	4812 259 28823	Heating element 240 V with NTC

Pos No	12NC	Description
480 0	4812 321 78412	Cable MOT-DOM 7
490 0	4812 321 18264	Connect.cable UK
491 0	4812 321 28367	Strain relief
491 1	4812 502 38152	Screw 4.8x19
521 0	4801 111 00294	Control unit DOMINO, programmed
521 0	4812 214 70725	Control unit DOMINO,C1W-basic
571 0	4812 271 28558	Valve magnet 1 inlet, 2 outlets
581 0	4812 271 28585	Pressostat 50/25 INVENS.
620 0	4812 239 58061	Module E1/7 Opt.
630 0	4812 280 58048	Door lock 3 tab
653 0	4812 134 18046	Light guide PROG.FLOW LOW
653 1	4812 134 18047	Guide,light start low
653 2	4812 134 48364	Guide,light 7 Opt.
691 0	4812 282 19485	Sensor NTC SC1,OMEGA3,DOMINO
701 0	4819 530 28848	Hose inlet Reflex
701 1	4819 466 69704	Gasket and filter
702 0	4812 530 29405	Hose valve-dispenser
707 5	4812 526 48035	Nozzle warm
708 1	4812 530 49392	Bend disp.-tub Eureka
711 0	4812 418 68437	Dispenser Box
712 0	4812 418 68415	Drawer
713 0	4812 418 68382	Safety device drawer
718 0	4812 418 89085	Siphon
718 1	4812 526 48252	Separator
754 0	4812 530 29495	Drainhose tub-pump Eureka
754 1	4812 530 28832	Lock eco
760 0	4812 480 58385	Filter pump
781 0	4812 530 29455	Hose draining outlet, COD
782 0	4812 530 29497	Hose Pressostat
794 2	4812 401 18549	Clamp hose
900 0	4812 255 18298	Holder outlet hose
900 1	4812 290 88123	Bracket EUREKA
900 2	4812 401 18501	Clamp hose 19.2 mm
900 3	4812 401 18446	Cable clamp
900 4	4812 401 18414	Clamp hose
900 5	4819 401 18529	Clamp hose
910 1	4812 502 48344	Screw
910 5	4812 903 08196	Screw M 5X14-Z
930 0	4812 492 38421	Spring suspension Eureka
961 0	4819 532 68829	Spacer
965 0	4812 466 68545	Cover BK/WH
993 0	4819 530 29028	Bow
993 3	4812 395 58004	Tool

Exploded View

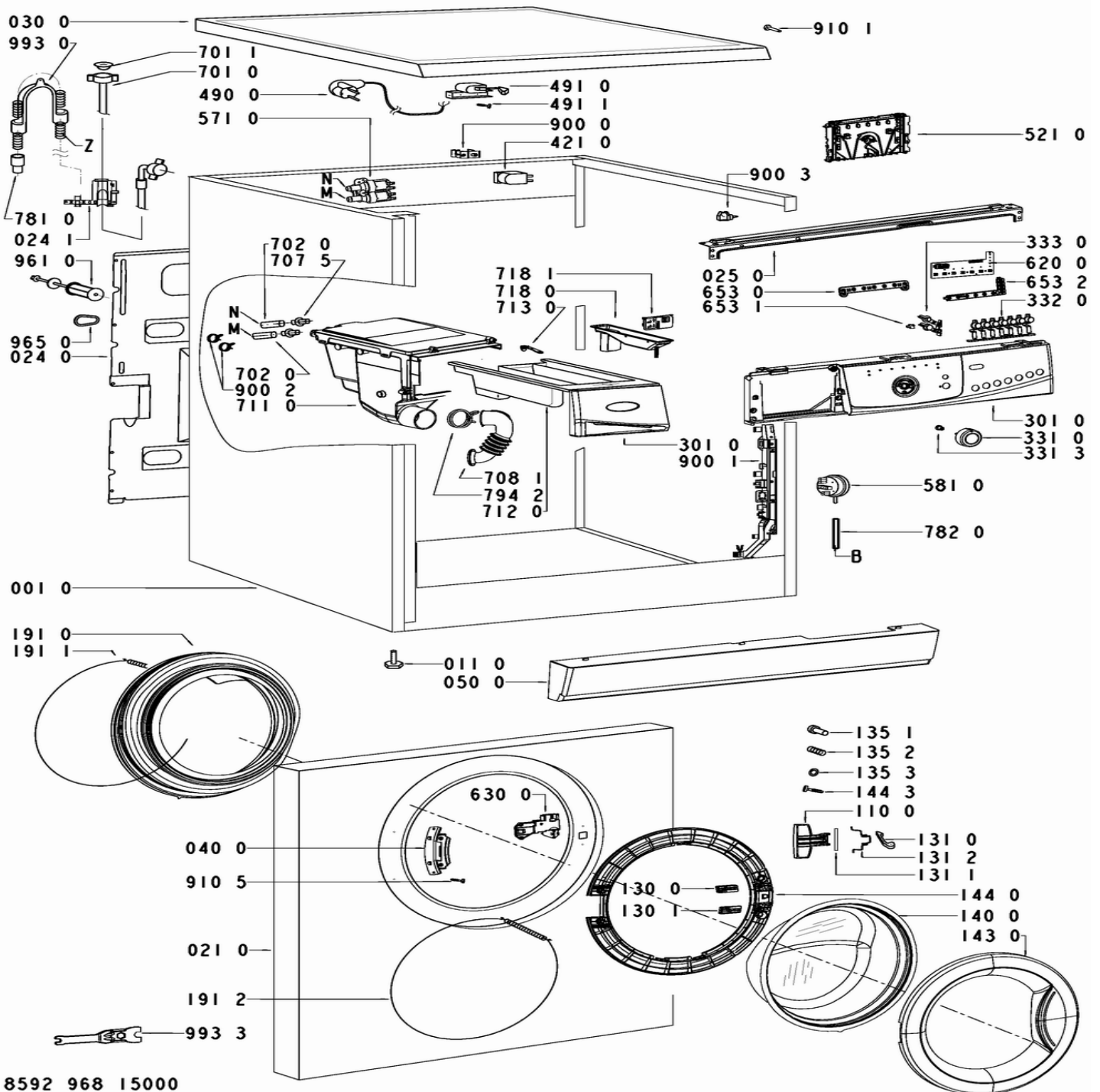

8592 968 15000

Exploded View

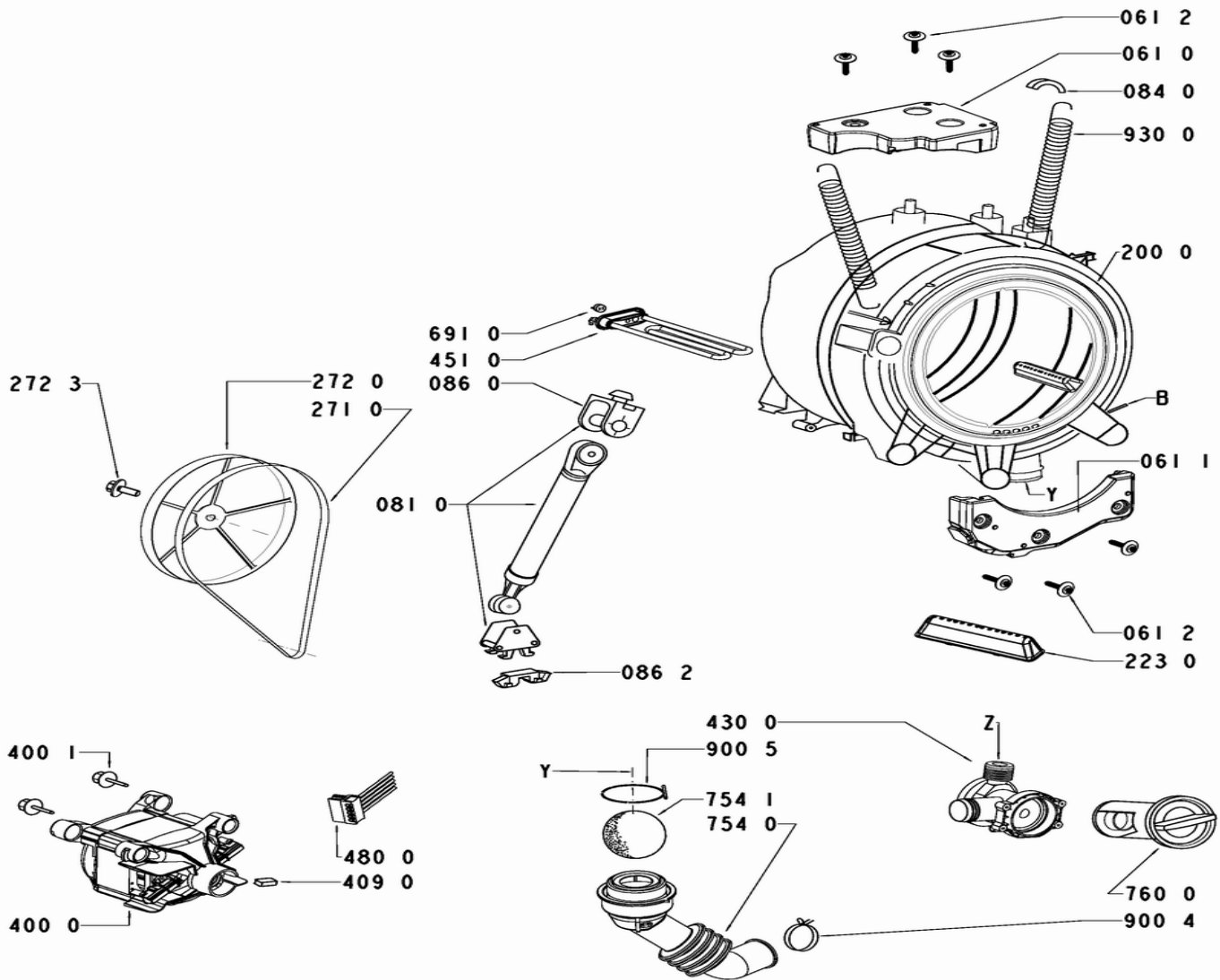

8592 968 15000

Technical Data

Dimensions + Weight

Product dimensions	
Height	85 cm
Width	59.5 cm
Depth	59 cm
Weight	
net	72 kg

Electrical base data

Voltage	240 V \pm 10 %
Frequency	50 Hz
Fuse	10 A
Power Consumption	~2.3 kW

Drum data

Volume	50 l
Wash speed	54 rpm
Spinning	
max.	1200 rpm

Pressostat

Level1	11 - 12/14
Overflow	11 - 16

Door lock

Kind of switch	Switch with PTC heater of bimetal
Nominal voltage	230 (90 - 264) V
Locking time	\leq 6 s
Unlock time	~85 s

Inlet valve

Rated flow	(1.5 - 5 bar)	8 l/min
Pressure range		0.3 bar - 10 bar
Nominal voltage		220 V - 240 V
Frequency		50 Hz
Nominal resistance	(20 °C)	3.8 k Ω

Drain pump

Nominal voltage		220 V - 240 V
Total power		30 W
Frequency		50 Hz
Resistor (coil)		160 Ω
Capacity	(0.55 - 1 m)	14 \pm 2 l/min

Heating element

Nominal voltage 240 + 10%, -15% V
 Total power 2050 W
 Resistance (20 °C) 28 Ω
 Leakage current < 0.8 mA

NTC sensor

Resistance NTC

0 °C	35.9	kΩ
30 °C	9.8	kΩ
40 °C	6.6	kΩ
50 °C	4.6	kΩ
60 °C	3.2	kΩ
70 °C	2.3	kΩ
95 °C	1.1	kΩ

Motor

Resistance contacts (20 °C)
 Stator (full field) 1.89 Ω
 Stator (tapped field) 0.84 Ω
 Rotor 2.15 Ω
 Tacho generator 68.7 Ω

Control unit

Type DOMINO
 Nominal voltage 230 - 240 V
 Frequency 50 Hz

Output control unit

Motor	M7.6 - DSS3.2	>40 V
Aquastop	AQ2.2 - DSS3.2	230 V
In pump step	AQ2.1 - DSS3.3	230 V
NTC	Not measurable	—
Pump	DP2.1 - DP2.2	230 V
Doorlock	DSS3.1 - DSS3.3	230 V
Pressostat	E4 - E2	230 V
- empty	PR2.1 - E2	230 V
- full	PR2.2 - E2	230 V
Valve (Rast 2.5)	V2.1 - V2.2	>170 V
Options	Not measurable	—

Wiring Diagram

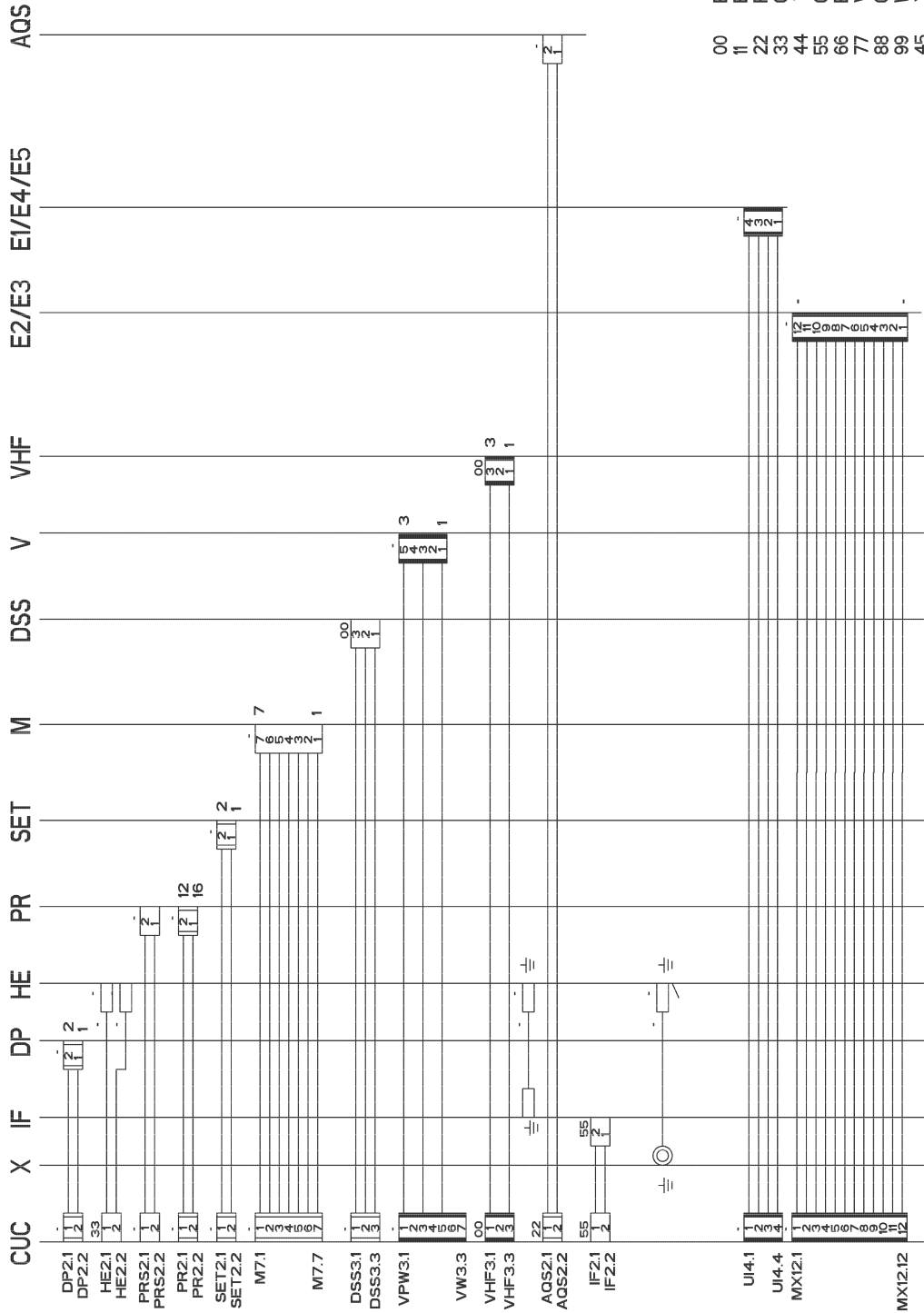

- 00 Black
- 11 Brown
- 22 Red
- 33 Orange
- 44 Yellow
- 55 Green
- 66 Blue
- 77 Violet
- 88 Grey
- 99 White
- 45 Yellow/Green

461971402641

Legend

00	Black
11	Brown
22	Red
33	Orange
44	Yellow
55	Green
66	Blue
77	Violet
88	Grey
99	White
45	Yellow/Green

Circuit Diagram

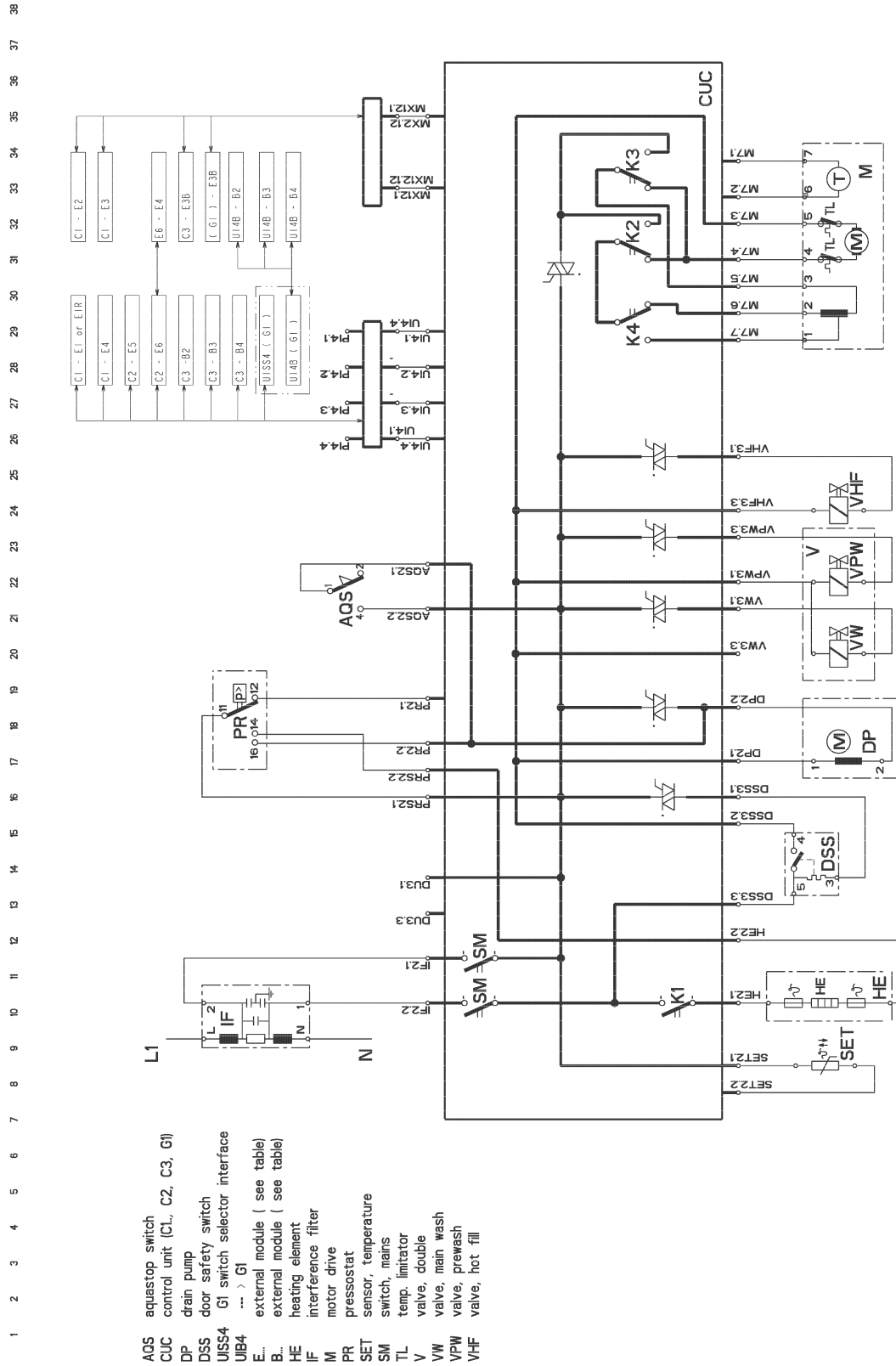

461971402231

Legend

AQS	aquastop switch
CUC	control unit (C1., C2, C3, G1)
DP	drain pump
DSS	door safety switch
UISS4	G1 switch selector interface
UIB4	---> G1
E...	external module (see table)
B...	external module (see table)
HE	heating element
IF	interference filter
M	motor drive
PR	pressostat
SET	sensor, temperature
SM	switch, mains
TL	temp. limitator
V	valve, double
VW	valve, main wash
VPW	valve, prewash
VHF	valve, hot fill

Program Chart

4619 714 18321

Wash Cycle of Cotton ≥ 50°C, Extra Care

Domino Eureka 473

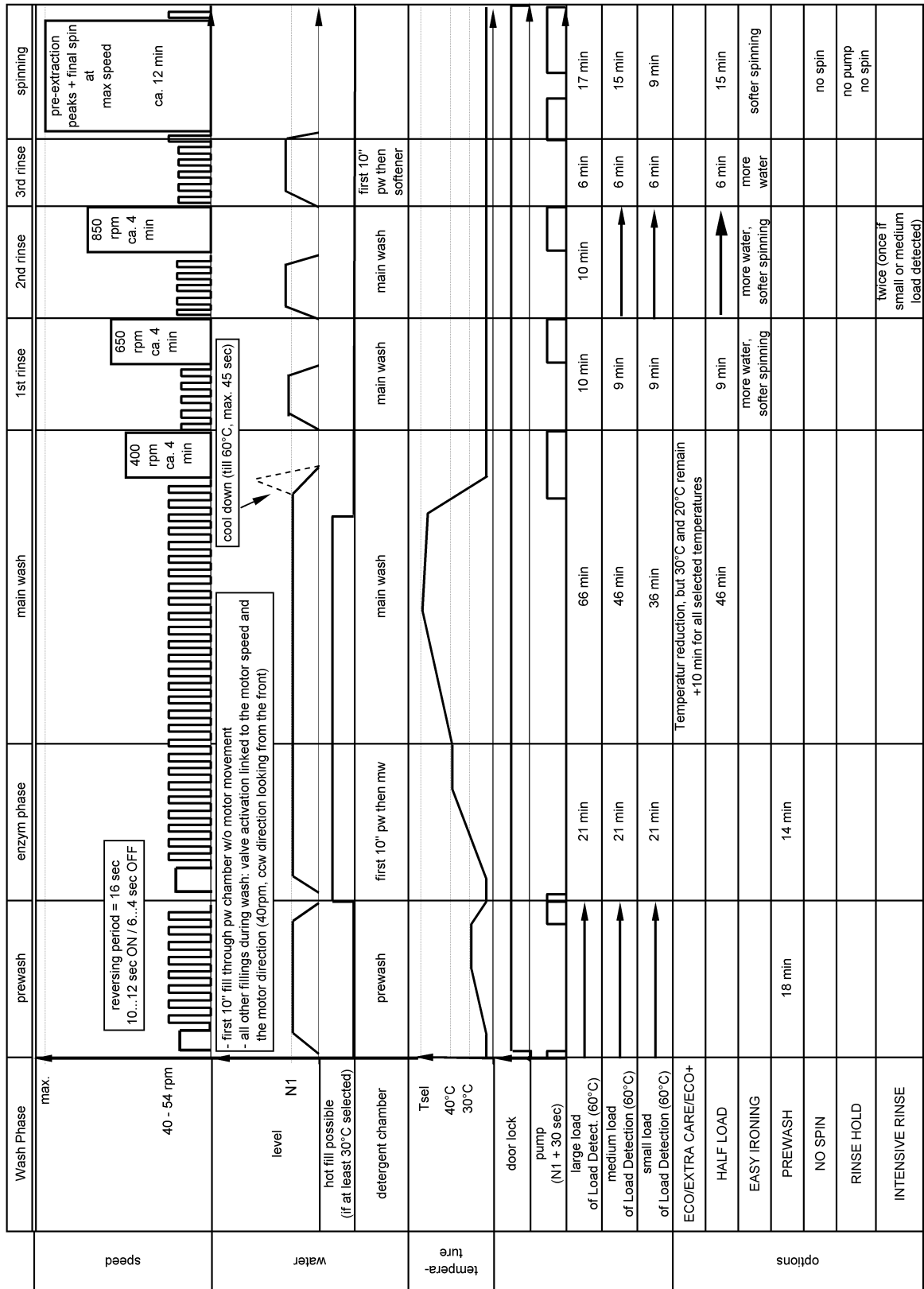

Program Chart

4619 714 18321

Wash Cycle of Cotton ≤ 40°C, Jeans/Baby

Domino Eureka 473

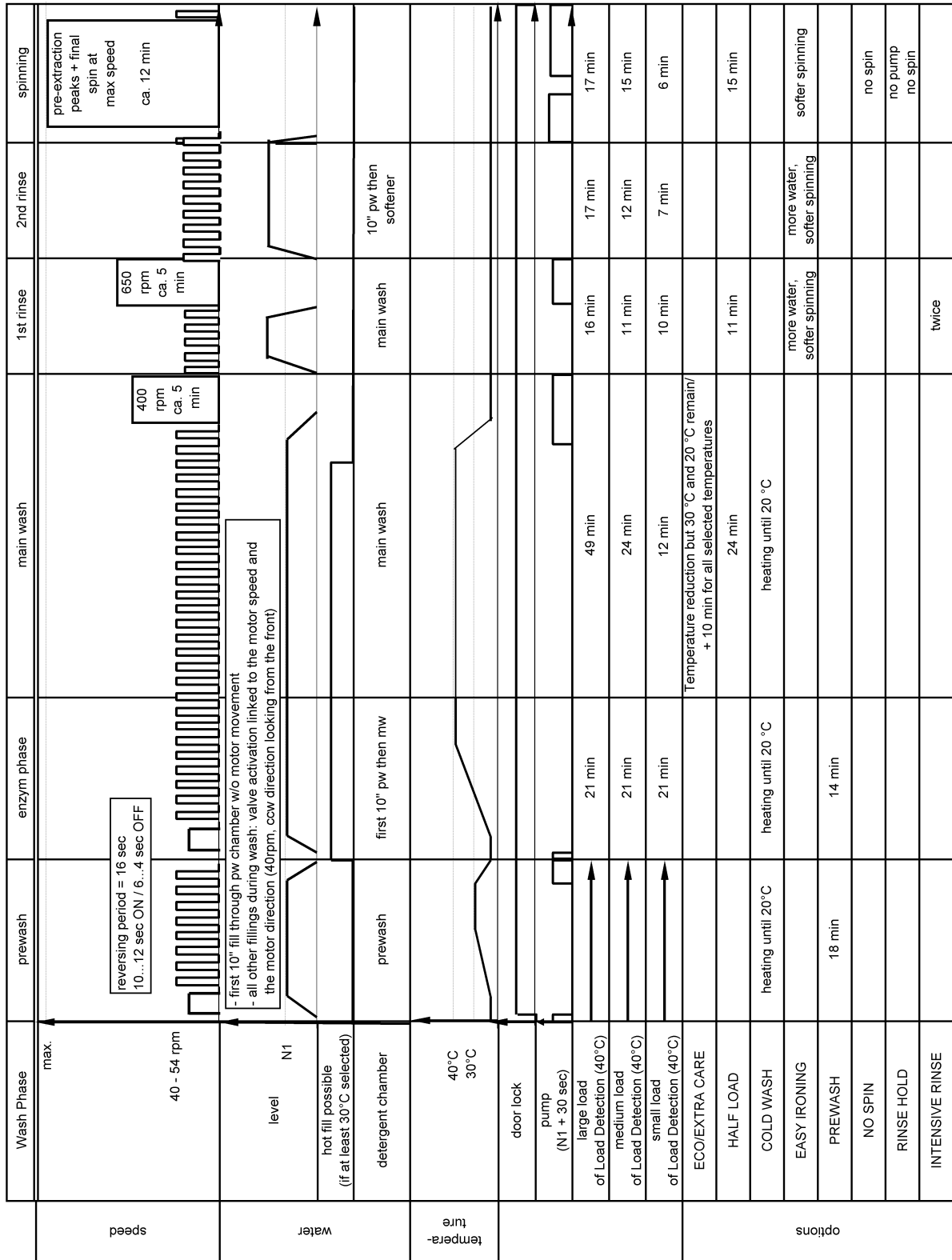

Jeans/Baby = Cotton 40°C with integrated intensive rinse option

easy ironing and intensive rinse are not selectable
The option LED of intensive rinse doesn't light.

Program Chart

4619 714 18321

Wash Cycle of SuperEco (for 5kg model available in March 2008)

Domino Eureka 473

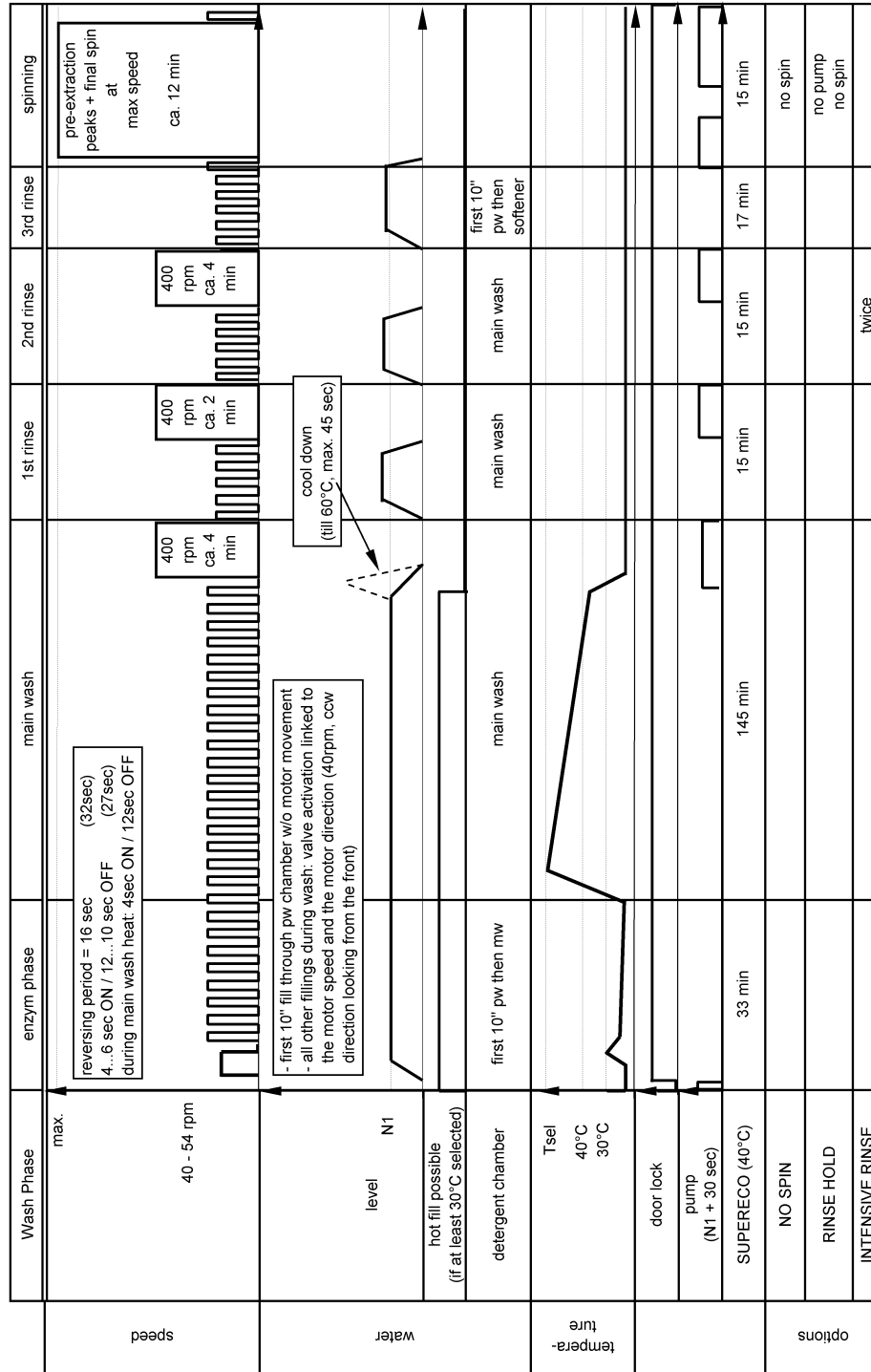

Program Chart

Domino Eureka 473 Wash Cycle of Synthetic/Easy Care, Sport/Leisure 4619 714 18321

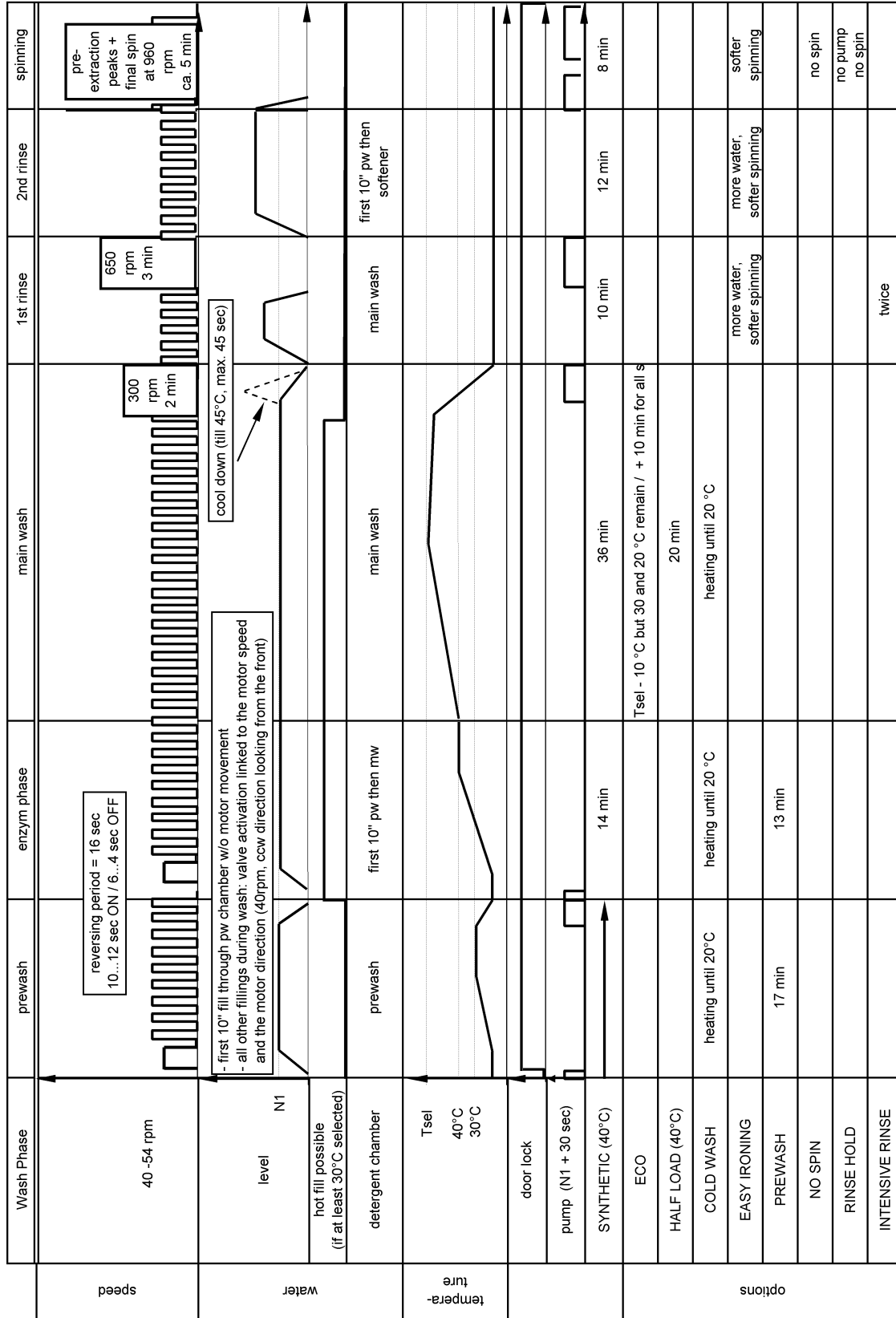

Sport = Synthetic 30°C with integrated prewash option
The options prewash and eco are not selectable

The option LED of prewash is off after selecting the cycle but after program start the program sequence lamp for prewash lights up.

Program Chart

4619 714 18321

Wash Cycle of Chrono/Daily (60min)

Domino Eureka 473

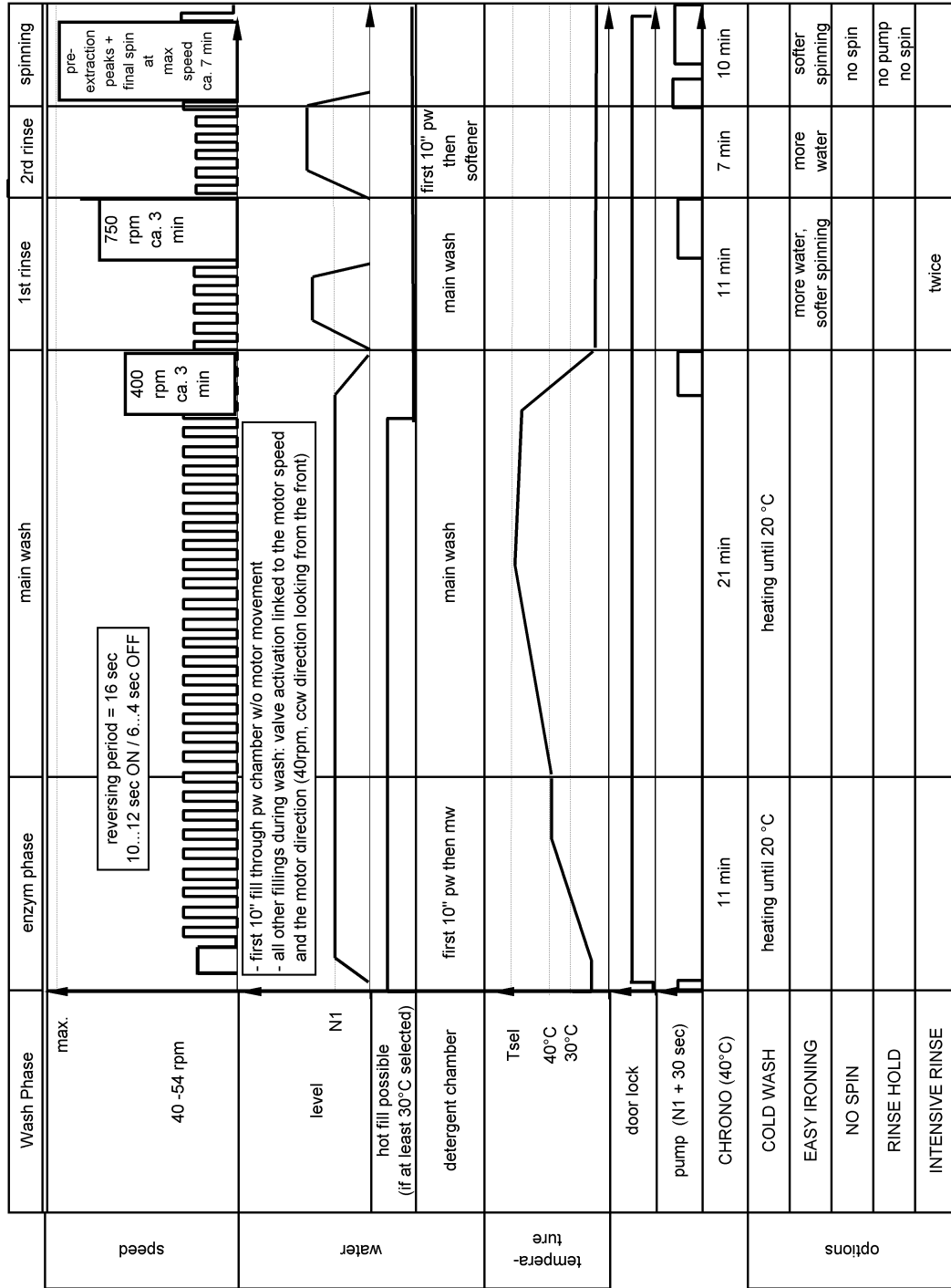

Program Chart

Domino Eureka 473 Wash Cycle of Express/Quick Wash/Chrono30/Superrapid (30 min) 4619 714 18321

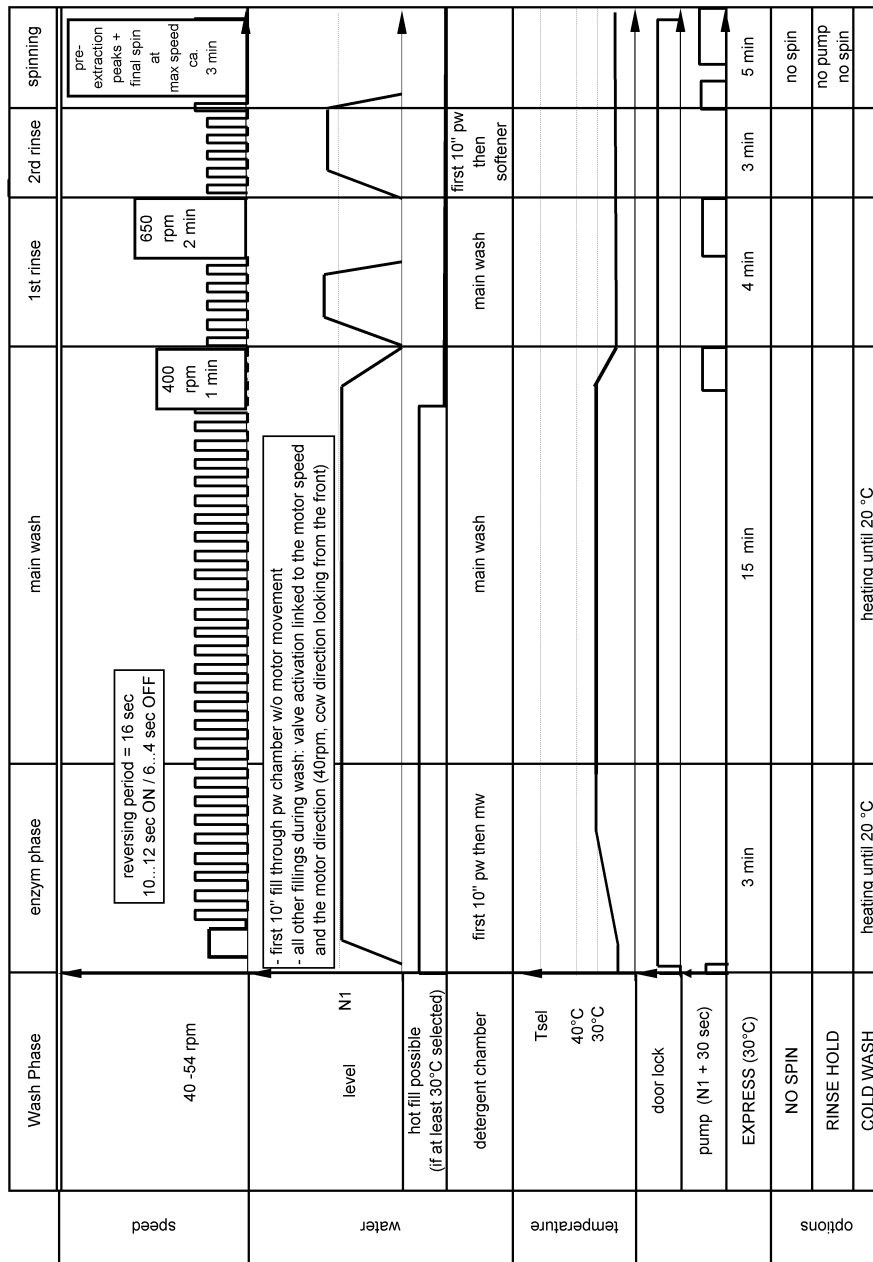

Program Chart

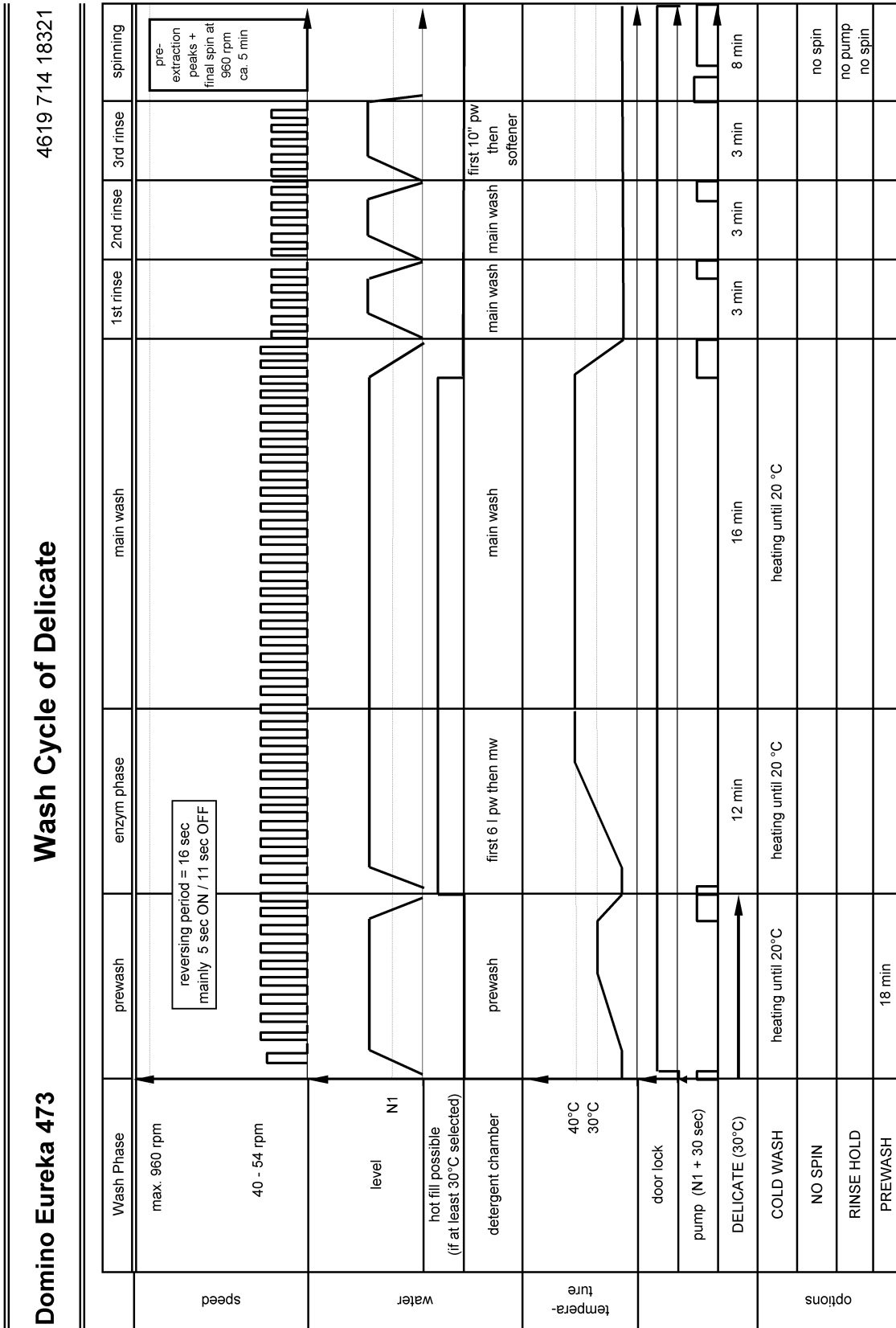

Program Chart

Domino Eureka 473 Wash Cycle of Wool, Handwash, Lingerie 4619 714 18321

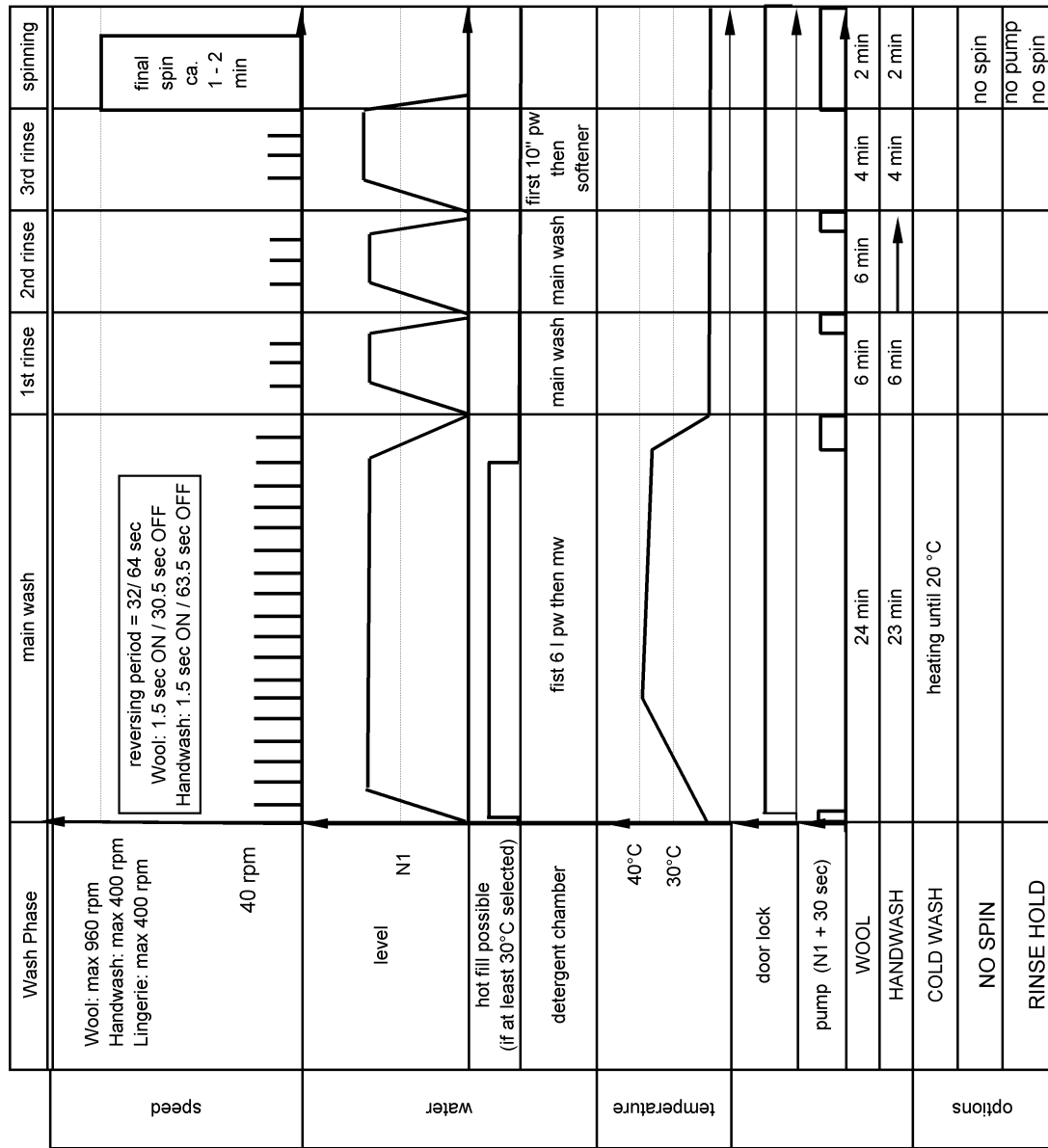

Lingerie: Handwash with default setting 30°C (40°C selectable)

The options cold wash, rinse hold and spin reduction are selectable

Program Chart

4619 714 18321

Spin Profiles

Domino Eureka 473

Cotton, Jeans, Baby (large load detection)

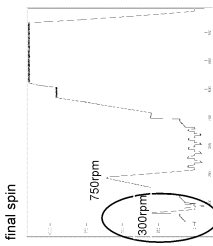
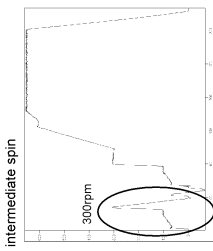

Chrono/Daily

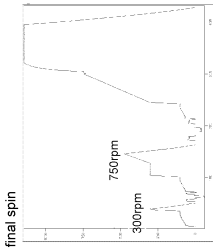
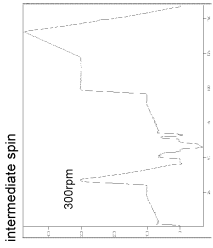

Express/Quick Wash/Chrono30/Superrapid

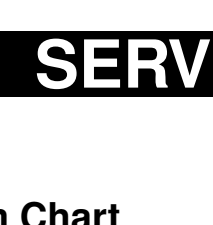

Synthetic/Easy Care, Sport/Leisure

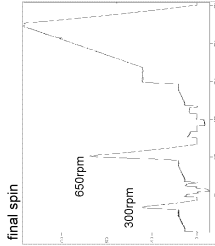
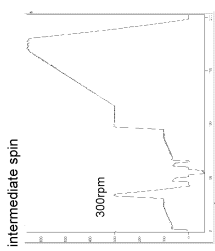

Wool

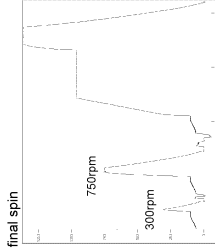
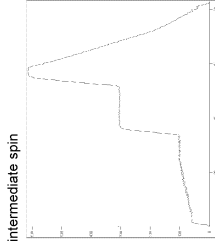

SuperEco

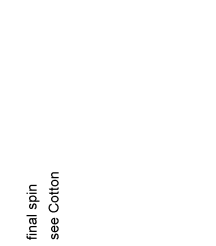

Handwash, Lingerie

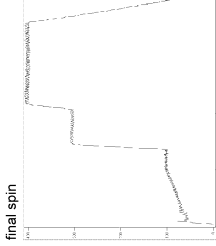



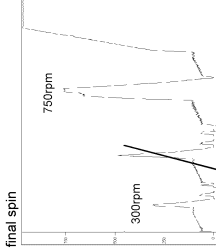



Delicate

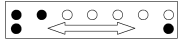

Testprogram





1. Switch ON the appliance
2. Close the Door
3. Selected the DRAIN program
4. Press Push button (PB) Reset 4 times within 5 seconds
5. Go to the next step press PB Reset twice

Attention: Use the test program only without laundry!

LED Status	Digits *	Description of the Program Flow	Check to perform
	-- 0	The door is locked. The CUC is performing the Selftest.	CUC detects • F02, F05, F08, F12, F13, F14, F15, F21, F23, F26
	-- 1	Fill 15" hot valve (only if hot fill appliance) Fill 15" in prewash (PW) Fill 15" in mainwash (MW) Fill 15" in PW + MW (Softener) Fill by MW to wash level. Motor is reversing.	Technician: • Check the valve activation • Check the dispensing into the dispenser • Check the pressure switch
	-- 2	The heating element is switched ON. Motor is reversing.	Technician: • Check heating element activation • Check if the motor is reversing CUC detects: • F06, F07, F27
	-- 3	The drain pump is switched ON until the wash level = OFF + 5" motor is reversing.	Technician: • Check drain pump activation • Check pressure switch operation • Check if the motor is reversing CUC detects: • F06, F07, F27, F03
	-- 4	The motor is driven to maximum speed. Drain pump is ON.	Technician: • Check if the motor is running at max. speed • Check drain pump activation CUC detects: • F28
	-- 5	Motor is switched OFF. Door is unlocked.	Technician: • Check if the door is unlocked CUC detects: • F13







- Digits 1,2, (the left on) are executing an animation

Error Codes

Failure Indication		Explanation and Recommended Procedure
On Status LEDs	On Digits if available	
	<p>Remaining Time</p>	<p>No water detected entering machine or pressure switch trip not detected.</p> <p>If after 6 minutes the control does not detect water entering machine and then valves will be turned off and the LED Water Tap will be switched ON.</p> <p>The Control is in Pause Mode. If it was possible to remove the failure, by pushing PB Start the appliance will restart.</p> <p>Potential Causes</p> <ul style="list-style-type: none"> • If there is no water in the unit: <ul style="list-style-type: none"> • Make sure that both valves at the water source(s) are turned on all the way. • Check for plugged or kinked inlet hoses or plugged screens in the inlet valves. • Verify inlet valve operation. • If there is water in the unit: <ul style="list-style-type: none"> • Pressure switch hose is in good condition and properly connected to tub and pressure switch. • Verify there is not a siphon problem. • Verify wire harness connections to; inlet valves, pressure switch and central control unit (CUC). • Check all hoses for possible leaks. • Verify pressure switch operation. • Verify CUC operation.
	<p>FA</p> <p>F02</p>	<p>Aquastop Failure</p> <p>If the aquastop contact on the bottom tray of the appliance is closed for more than 30' an aquastop failure will be detected. In aquastop condition, the door will remain locked and the drain pump will run constantly.</p> <p>Potential Causes</p> <ul style="list-style-type: none"> • If there is water in the bottom tray of the appliance: <ul style="list-style-type: none"> • Check all hoses for any leakage. • Check if there was an overfoam due to too much detergent used. • Check the tub for any leakage. • If there is no water in the bottom tray <ul style="list-style-type: none"> • Check if the aquastop switch has a short circuit. • Check if the aquastop wiring is properly connected. • Verify CUC operation. (Check also for F26: Pump Triac Short Circuit is causing this code.)
	<p>Remaining Time</p> <p>During test program</p> <p>F03</p>	<p>Long Drain</p> <p>If the drain time exceeds 4 minutes, the LED clean Filter is turned ON.</p> <p>The control is in Pause Mode. If it was possible to remove the failure, by pushing PB Start the appliance will restart</p> <p>Potential Causes</p> <ul style="list-style-type: none"> • Check the drain hose and make sure it is not blocked or kinked • Check the electrical connections at the pump and make sure the pump is running. • Check the drain pump filter for foreign objects. • Check the electrical resistance of the drain pump. • The failure ca also be generated by too much foam in wash phase. Read also failure description F18.
	<p>F04</p>	<p>Too Long Heat Time</p> <p>If the water temperature is not increasing over 35°C during 40 minutes of the first heating step in the cycle the CUC will display this Error.</p> <p>Potential Causes</p> <ul style="list-style-type: none"> • Check the electrical resistance of the heating element. • Check Wire Harness connections to the heating element, NTC and CUC. • Check the electrical resistance of the NTC (failure can also occur, when NTC resistance is not changing with temperature)
	<p>F05</p>	<p>Water Temperature Sensor Error</p> <p>If during the water heating step in the wash cycle, the water temperature sensor (NTC) value is out of range, the F05 error code will be displayed.</p> <p>Potential Causes</p> <ul style="list-style-type: none"> • Check the NTC resistance. • Check connections to the NTC and CUC.

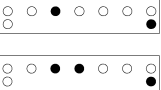
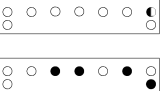

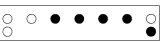



DOMINO 4619 714 04651

Error Codes

	<p>F06</p>	<p>Drive Motor Tachometer Error</p> <p>The control is unable to properly detect motor speed (several times) and the machine will shut down. If a failure occurs during high speed spin the door will be unlocked after the drum has stopped rotating.</p> <p>Potential Causes</p> <ul style="list-style-type: none"> • Check wire harness connections between the motor and CUC. • Check the resistance of the tachometer circuit on the motor. • Check resistances of the motor windings.
	<p>F07</p>	<p>Motor Control Triac Error</p> <p>The main control has detected a short circuit in the motor control triac. If a failure occurs during high speed spin the door will be unlocked after the drum has stopped rotating.</p> <p>Potential Causes</p> <ul style="list-style-type: none"> • Check CUC by running Test Program.
	<p>F08 F12</p>	<p>Heater Circuit Error</p> <p>The main control has detected a heater circuit failure. This failure modes are checked before the cycle starts and after the spinning steps.</p> <p>Potential Causes</p> <ul style="list-style-type: none"> • Check the resistance of the heater connectors to the ground. • Check the resistance of the heater. • Check the wiring connectors to the heater and CUC. • Check the CUC.
<p>LED Door open flashing for 10"</p> 	<p>Only during test program</p> <p>F13</p>	<p>Door Open LED flashing after the cycle is started</p> <p>If the CUC is not able to lock the door of the washer after program start within 10", the door open LED will flash for 10".</p> <p>If the CUC is not able to unlock the door at the end of program within 240", this code will be displayed. After switch OFF and ON, CUC will again try to open the door lock for 240". During this phase all LEDs will be OFF. If this is again not successful, Code will appear after 240".</p> <p>Potential Causes</p> <ul style="list-style-type: none"> • Check if the door is closed properly. • Check if there is a mechanical problem on the door lock system. • Check the wiring/harness between the CUC and the door lock. • Start the Test Program. If the problem persists the error Code F13 will be displayed.
	<p>F14</p>	<p>EEPROM Error</p> <p>The CUC receives it's data from an EEPROM on board the CUC. If there is an error reading this data it will cause this failure indication.</p> <p>Potential Causes</p> <ul style="list-style-type: none"> • A power glitch (mains disturbance) may cause this error: Run the Test Program. This will perform a complete check of the EEPROM. If the failure is detected during the Test Program replace the CUC.
	<p>F15</p>	<p>Drum Up Circuit Missing (only for TOPLOADERS with DRUM UP Circuit)</p> <p>If the CUC is not detecting the Drum Up switch closing during motor rotation this failure is displayed. This error is detected ONLY during the Test Program.</p> <p>Potential Causes</p> <ul style="list-style-type: none"> • Check the position of the electromagnetic device. • Check the position of the reed sensors. • Check the resistance of the reed sensor. • Check the wiring connection between the reed sensor and the CUC.
	<p>F18</p>	<p>Foam detected During the Wash Cycle</p> <p>If the CUC is not able to drain out the water after washing or not able to spin after several trials this alarm Code is displayed.</p> <p>Potential Causes</p> <ul style="list-style-type: none"> • Customer used too much detergent. • Check if there is any problem with the pump hoses. • Check the pump for foreign objects. • Check the electrical resistance of the pump. • Check the electrical resistance of the pressure switch. • Check if pressure switch hose is in good condition and properly connected to tub and pressure switch. • Verify there is not a syphon problem.

DOMINO 4619 714 04651

Error Codes

	<p>F21</p>	<p>User Interface Error (detected only with display user interfaces)</p> <p>If the communication between user interface module and CUC is disturbed, this Error is displayed. If the failure is displayed on the digits the display module is not able to "talk" to the CUC. If the failure is displayed on the status LED the CUC is not able to contact the Display module.</p> <p>Potential Causes</p> <ul style="list-style-type: none"> • Check wiring connection to the display module. • Check display module. • Check CUC.
	<p>F23</p>	<p>Pressure switch Failure</p> <p>If the CUC detects during the wash cycle that the pressure switch contact for the wash level and the pressure switch level for the heater safety are ON or OFF simultaneously for 10" this failure will be displayed.</p> <p>Potential Causes</p> <ul style="list-style-type: none"> • Check the resistance of the pressure switch contacts. • Check the wiring of the connection to the pressure switch and to the CUC. • Start the Test Program. If the problem persists F23 will be displayed. • Check points of F08 / F12 (Failure can be caused also by Heater circuit failure).
	<p>F24</p>	<p>Overflow Failure</p> <p>If the overflow contact on the pressure switch is closed for more than 60" the overflow failure will be indicated. In this overflow condition, the Door will remain locked and the drain pump will run constantly.</p> <p>Potential Causes</p> <ul style="list-style-type: none"> • Check the drain hose and make sure it is not blocked or kinked. • Check Wire Harness connections to the drain pump, pressure switch, and CUC. • Check/clean drain pump filter of foreign objects. • Check for drain pump failure. • Check the inlet valve for proper shut off. • Check the pressure switch for proper operation.
	<p>F26</p>	<p>Pump Driver Failure</p> <p>If the CUC detects that the triac of the pump is defective it will display this failure.</p> <p>Potential Causes</p> <ul style="list-style-type: none"> • Check the resistance of the pressure switch contacts. • A failure of the pressure switch could also cause the Code. • If OK. Start test program to check the CUC. If the failure occurs replace the CUC.
	<p>Only during test program</p> <p>F27</p>	<p>Reversing relay failure</p> <p>If the CUC detects that the motor is possible to rotate only in one direction this failure is displayed.</p> <p>Potential Causes</p> <ul style="list-style-type: none"> • Check the harness to the motor. • Check the CUC.
	<p>Only during test program</p> <p>F28</p>	<p>Tapped Field Failure</p> <p>If the CUC is not able to switch ON the tapped field of the Motor, this failure code is displayed.</p> <p>Potential Causes</p> <ul style="list-style-type: none"> • Check if the correct motor is build in. • Check the resistance of the fields of the motor. • Check the harness between Motor and CUC. • If the points above are OK replace the CUC.
	<p>F31</p>	<p>Blocked Drum Detected (only for Top Loader Appliances)</p> <p>CUC detects problems with driving of the motor at the beginning of the cycle or after pause mode when door lock have been unlocked.</p> <p>Potential Causes</p> <ul style="list-style-type: none"> • Check if the Drum door are properly closed • Check the Belt position • Check the F06 Case

Error Codes

	<p>Only during test program</p> <p>F40</p>	<p>MEB Communication Failure / Low Ambient Temperature</p> <p>If there is no communication between CCU and the Myst Extension Board (MEB) or if the ambient temperature is lower than 5 °C this failure Code will be displayed.</p> <p>Potential Causes</p> <ul style="list-style-type: none"> • Check if there is power at the MEB CU2 connector. • Check if the communication cable is connected to the MEB and to the UI. • Check if the ambient temperature is higher than 5 °C. • If the points above are OK replace the MEB.
	<p>Only during test program</p> <p>F41</p>	<p>MEB Control Board Failure</p> <p>If there is any failure detected at the Myst Extension Board (MEB) this failure Code will be displayed.</p> <p>Potential Causes</p> <ul style="list-style-type: none"> • Check if there is power at the MEB CU2 connector. • If the point above is OK replace the MEB.
	<p>Only during test program</p> <p>F42</p>	<p>Steamer Component Failure</p> <p>If there is any failure at the steamer component or steamer NTC, this failure Code will be displayed.</p> <p>Potential Causes</p> <ul style="list-style-type: none"> • Check the harness between Steamer, NTC and MEB. • Check if there is no fuse or resettable thermostat at open state. • Check the electrical resistance of the Steamer Heater. • Check if the NTC is not at open or short-circuit state. • Check if the steamer hoses are connected. • Check if the steamer tube is not blocked. • If the points above are OK replace the steamer component.
	<p>Only during test program</p> <p>F43</p>	<p>Steam Valve Failure</p> <p>If there is no water supply or the steamer valve does not open this failure Code will be displayed.</p> <p>Potential Causes</p> <ul style="list-style-type: none"> • Check if water supply for the appliance is not closed. • Check if the cable between MEB and valve is connected. • Check if the hoses to the valve are connected with no leakage. • If the points above are OK replace the valve. • Re-test the machine and if the failure persists replace the MEB.

Domino Class B safety functions:

- 1) **Wash Level activated during selection mode:**
The Door is locked and Drain routine is started. If the Drain Pump is not defective the Door will be unlocked after Level N0 + 30seconds;
Led (display) status: normal indication
If Drain Pump is defective Pump failure will be retriven.
- 2) **Drum Speed is higher than 60rpm in selection mode:**
When the speed > 60 rpm, then after 4 seconds, the doorlock is activated.
Led (display) status: normal indication
- 3) **Water High Temperature in selection or pause mode:**
If temperature which NTC sensor is detecting is higher than 50°C Door Lock will kept locked.
Led (display) status: normal indication

DOMINO 4619 714 04651